

DHW Heat Pump

PRODUCT SHEET



 Product certified by: 

FEATURES

Model	COMPAK KHP 16 190S	COMPAK KHP 23 300S
Heating capacity ¹	1,62 kW	2,30 kW
Heating power input ¹	0,42 kW	0,53 kW
Tank volume	168 L	272 L
Air flow	270 m ³ /h	414 m ³ /h
Sound pressure	36,60 dB(A)	38,20 dB(A)
Working weight	310 kg	435 kg
Max. temperature DHW	70°C	70°C
Temperature range outdoor (without backup heater)	-7°C - 43°C	-7°C - 43°C
Hydraulic connections	Ø3/4"	Ø3/4"
ASP	25 Pa	25 Pa
Backup heater	3 kW	3 kW
Exchanger	Copper coil	
Tank	Enamelled	
Solar coil	1,10 mm ²	1,30 mm ²
Power supply	220-240 V / 1 ph / 50 Hz	
Power wiring	4 mm	4 mm
Max. overcurrent protection	40 A	40 A

¹ Outdoor temperature 15/12°C (DB/WB), water inlet 15°C, water outlet 45°C

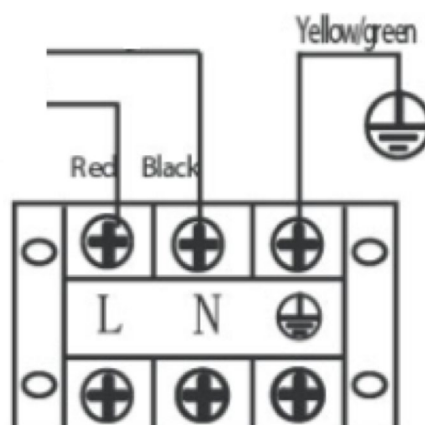
WIRING DIAGRAM

NOTES:

- (1) The data and specifications present in this sheet may vary without notice.
- (2) The images on this sheet are indicative and may be different from the final machine.

DIMENSIONS OF UNIT & SPACE FOR INSTALLATION

COMPAK KHP 16 190S

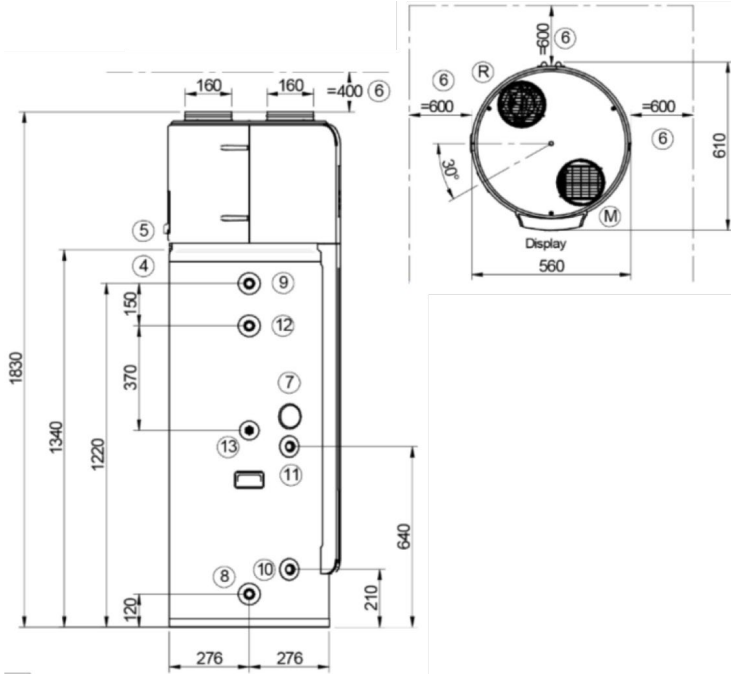

COMPAK KHP 23 300S

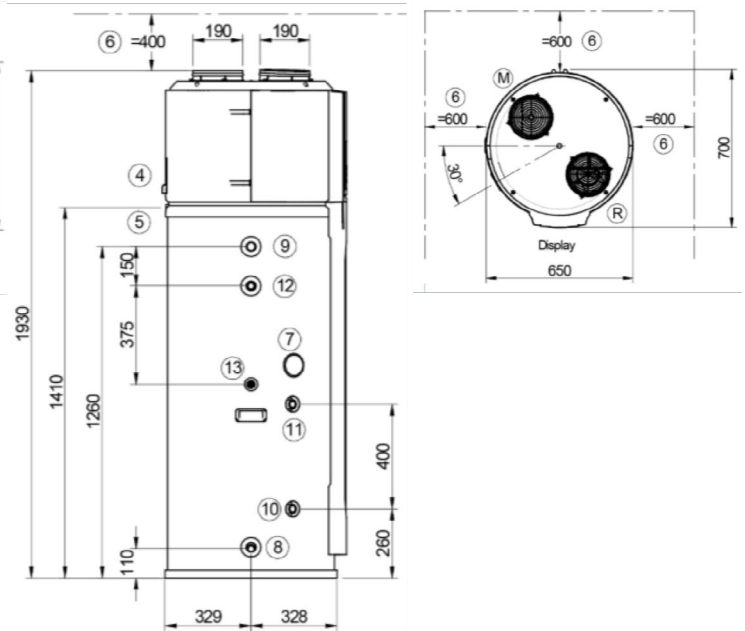

1 Compressor compartment	6 Functional spaces	11 Solar output 3/4" H (only 300S)
2 Distribution panel	7 Magnesium anode	12 Solar recirculation 3/4" H (only 300S)
3 Unit keyboard	8 Water inlet 3/4" H	13 Solar probe holder
4 Power line input	9 Water outlet 3/4" H	R Air return
5 Condensate discharge	10 Solar entrance 3/4" H (only 300S)	M Air drive

RECOMMENDED CHANNELING OF AIR

COMPAK KHP 16 190S

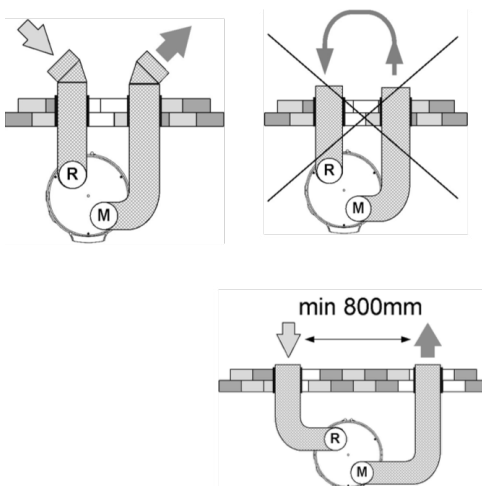

COMPAK KHP 23 300S

